

specifications

FDM1500r

SKOPE Food Display Cabinet
REMOTE Type: F1521

CABINET DIMENSIONS

	External	Internal
Height:	1305mm	800mm
Width:	1500mm	1200mm
Depth:	662mm	600mm
Floor area:	0.99m ²	

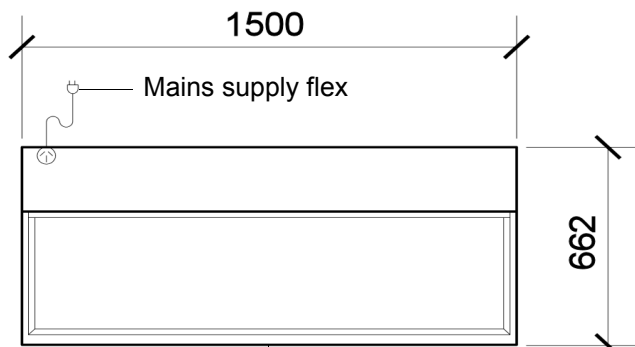

Glass front, sides and top

Adjustable angle shelves

Sliding glass rear doors

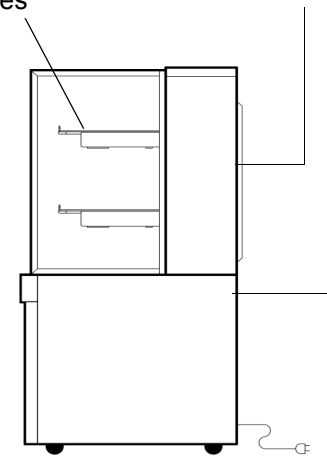
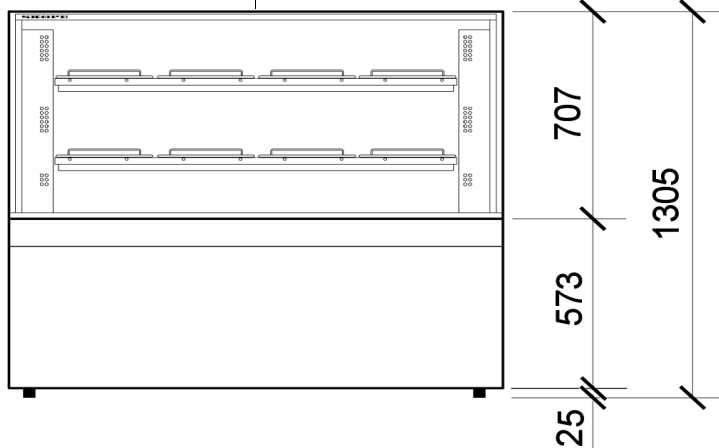

Electronic controller display with unit and lighting on/off switches

Copyright © 2007 SKOPE Industries Limited

CABINET SPECIFICATIONS

Refrigeration system:	Remote Food Display Refrigeration Unit with electronic controller
Refrigerant:	R134a / R404A
Pipe connection size:	Liquid line: 1/4". Suction line: 3/8"
Remote refrigeration duty:	620 Watts
Cabinet internal volume:	576 litres
Insulation:	50mm polyurethane foam
Cabinet temperature range:	+1° C to +7°C in 32° ambient
Drainage:	Plumbing required
Electrical:	220-240 Volts a.c. 50 Hz, single phase supply, 0.9 Amp
Internal lighting:	3 x 28 Watt T5 fluorescent tubes (Ø16mm x 1150mm) Daylight 860
Rear doors:	2 double-glazed sliding doors with internal mirror finish
Internal door opening size:	2 rear door openings: 540mm wide x 630mm high
Shelves:	3 shelves (2 adjustable angle): 1230mm wide x 440mm deep
Total weight:	175 kg

SKOPE Industries Limited reserve the right to alter specifications without notice.

PSS0173 Rev 3.1 Apr. 2016



SKOPE INDUSTRIES LIMITED



New Zealand Freephone: 0800 947 5673, Fax: (03) 983 3896. Australian Freephone: 1800 121 535, Freefax: 1800 121 533

Email: enquiry@skope.co.nz Website: www.skope.co.nz