

Six Drawer, Two Bay, Underbench GN₁/1 Freezer

Range: ProSpec
SKOPE ID: P1BF2A-A4
Dimensions: 1290 mm (W) × 700 mm (D) × 850 mm (H)
Gross Volume: 288 L

Project: _____

Item #: _____



A six drawer underbench freezer designed for busy kitchens at venues such as restaurants, clubs, pubs, and cafés. The freezer is engineered to continue working effectively in ambient environments of up to 40°C (climate class 5). With GEMS-certified 5L1 performance, standard storage temperatures range from -21°C to -18°C, or are adjustable via the SKOPE-connect smartphone app from -26°C to -12°C. The freezer is made from food-safe 304 AISI stainless steel throughout the interior and exterior. The 700 mm deep cabinet with a fully welded integrated worktop can be configured to suit multiple installation options. At 850 mm overall height, it can be positioned under a bench on the supplied castors, positioned on a pre-installed plinth by removing the castors, or fitted with optional legs for a finished working height of 900 mm. The six GN-compatible soft-closing drawers are fitted with ergonomic 3 mm gauge stainless steel handles and built-in barrel locks. The freezer is fully configurable, with the drawers swappable for either solid door or two GN drawer bays. The slim left-hand service compartment features an easily removable and cleanable condenser filter. The fully removable refrigeration cartridge uses R290 natural refrigerant for low energy consumption, low heat discharge, and low noise output. Right-hand services are also available. It is fully front breathing, with no side or rear clearance space required, and the cartridge can be easily removed in line with best practice for safe servicing of flammable refrigerants. The freezer includes a smart controller that connects to the free SKOPE-connect app to enable you to set temperatures and alerts, monitor temperatures and energy, and more. The freezer is certified to all Australian and New Zealand refrigeration and electrical safety standards.



Warranty



Natural Refrigerant



GEMS



304 Stainless Steel



GN-compatible



SKOPE-connect

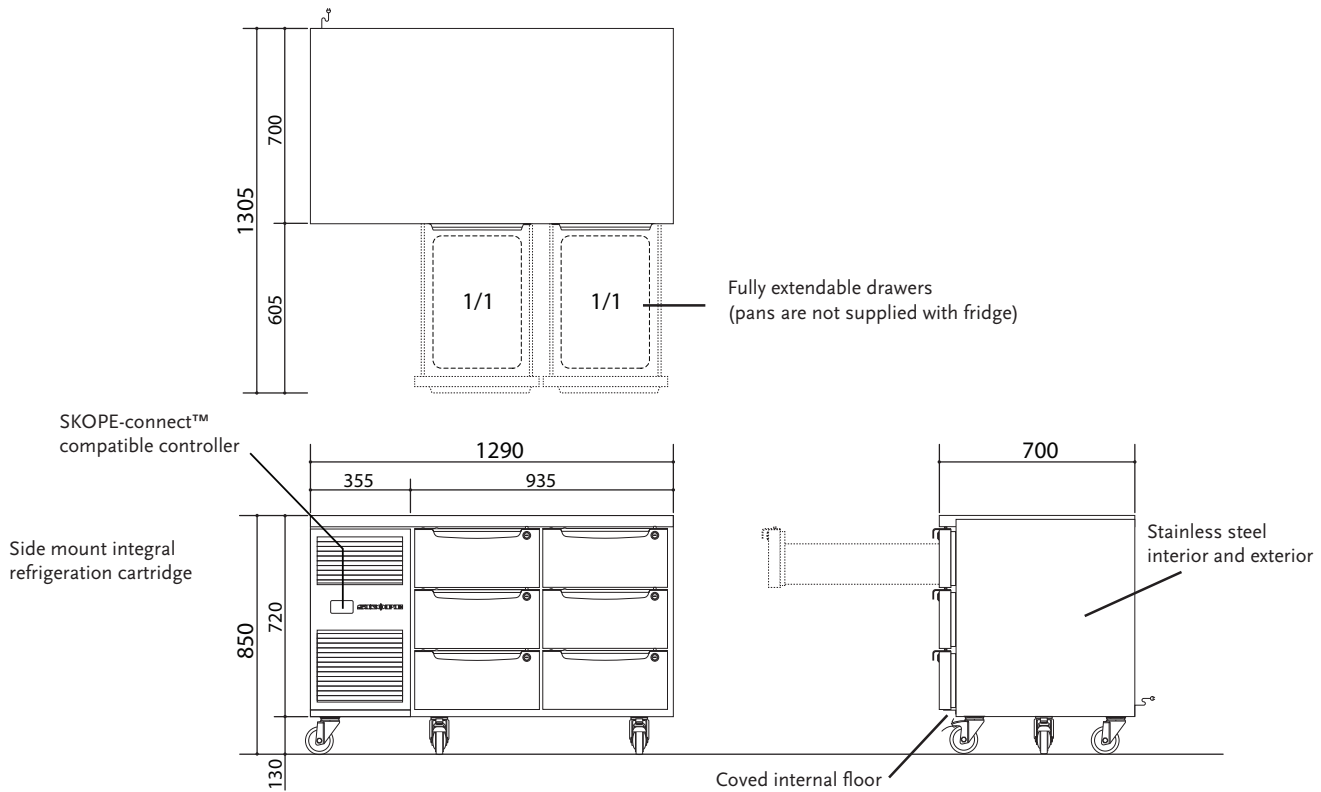

Cabinet

Type	Underbench		
Finish	304 AISI stainless steel		
Insulation	Type	PU foam	
	Thickness (mm)	50	
	Blowing Agent	Cyclo-iso pentane (C5H10/C5H12)	
Drawers	Lock	Barrel lock	
	Width (mm)	300	Depth (mm) 525
Gastronorm	Size 1/1		
Lighting	None		

Dimensions†

	External	Internal	Packed
Width (mm)	1290	820	1350
Depth (mm)	700	580	770
Height (mm)	850 (standard castors)	605	900
	860 to 900 (legs) 720 (plinth mount)		
Weight (kg)	148	160	
Gross Volume (L)	288		
Footprint (m ²)	0.9		

Ventilation (mm)

Top	Sides	Rear
Not required	Not required	Not required

Dimensional Tolerances

† Allow for dimensional tolerances when installing the cabinet(s).

Linear dimensions	Single cabinet		Multiple cabinets	
			At each joint	At each end wall
Less than 1 metre	±5 mm		±5 mm	+15 mm
More than 1 metre	-5 mm to +10 mm		-5 mm to +10 mm	+15 mm

Performance

Product Temperature Range (°C)	-21 to -18 (adjustable* from -26 to -12)	
Maximum Ambient Temperature (°C)	40	
Sound Level (dB(A))	Standard	63.7

Greenhouse and Energy Minimum Standards (GEMS)

Star Rating	n.a.	
Product Temperature Class	L1 (less than -18°C)	
Total Energy Consumption	n.a. kWh/24 h	
Annual Running Costs	\$n.a. (@ \$0.30/kWh)	

Electrical

Supply	220-240 volts a.c., 50 Hz, single phase supply	
Cord	2 m power cord with 3-pin, 10 amp plug	
Current Draw (A)	3.6	

Refrigeration

Controller	SCS Connect (SKOPE-connect™ compatible)	
System Type	Removable cartridge	
Cartridge Weight (kg)	30	
Refrigerant/Charge	R290/97 g	
Nominal Capacity (W)	535	
Heat Rejection (W)	Average 180	Peak 230
Defrost Type	Hot gas	
Drainage	No plumbing required	



PG11.UBF.2.D6
on the SKOPE website