

## Two Glass Door Top Mount Upright Fridge

**Range:** TME

**SKOPE ID:** PH10BYA

**Dimensions:** 1130 mm (W) × 730 mm (D) × 2210 mm (H)

**Capacity:** 897 L

**Project:** \_\_\_\_\_

**Item #:** \_\_\_\_\_



A high-efficiency, top-mounted, heavy duty, 2-door display fridge suitable for front and back-of house applications including restaurants, cafés, clubs, pubs, bars, quick service restaurants, and more. Made from powder-coated, galvanised steel, the cabinet comes complete with ten plastic-coated wire shelves per door, easily adjustable via SKOPE's unique ezi-clip and numbered shelf supports. The Gen3 aesthetic glass doors provide maximum product viewing and are designed for condensation protection via the double-glazed, argon-filled, double low-e, insulated panels. The high impact built-in LED lights can be timed to turn on and off according to your opening times via the free SKOPE-connect smartphone app. An illuminated sign panel is included, displaying backlit branding. With M1 compliance, the fridge is engineered to store food and drinks at a standard 1°C to 4°C (adjustable up to 15°C). This high-performance model is the most energy efficient on the market, and is certified under GEMS to the mandatory climate class 3. It is fully tested to operate in ambient environments of up to 40°C (climate class 5). The fridge uses R290 natural refrigerant for ultra-low energy consumption, low heat discharge, and low noise output. The top-mounted, fully removable, modular refrigeration cassette can be easily removed in line with best practice for safe servicing of flammable refrigerants. With the same cassette being used in both top and bottom-mounted fridges from 600 L to 1000 L, you achieve the fastest possible servicing times with minimal business disruption. The fridge includes a smart controller that connects to the free SKOPE-connect app, enabling you to set temperatures and alerts, monitor temperatures and energy, and more. The fridge is certified to all Australian and New Zealand refrigeration and electrical safety standards.



Warranty



ActiveCore Technology



Natural Refrigerant



GEMS



SKOPE-connect

© 2024 SKOPE Industries Limited | We reserve the right to alter specifications without notice.

Email: [skope@skope.com](mailto:skope@skope.com)

AUS Freephone: 1800 121 535

NZ Freephone: 0800 947 5673

[skope.com](https://skope.com)

PSS1192 | Rev. 1.1 | Oct. 2024



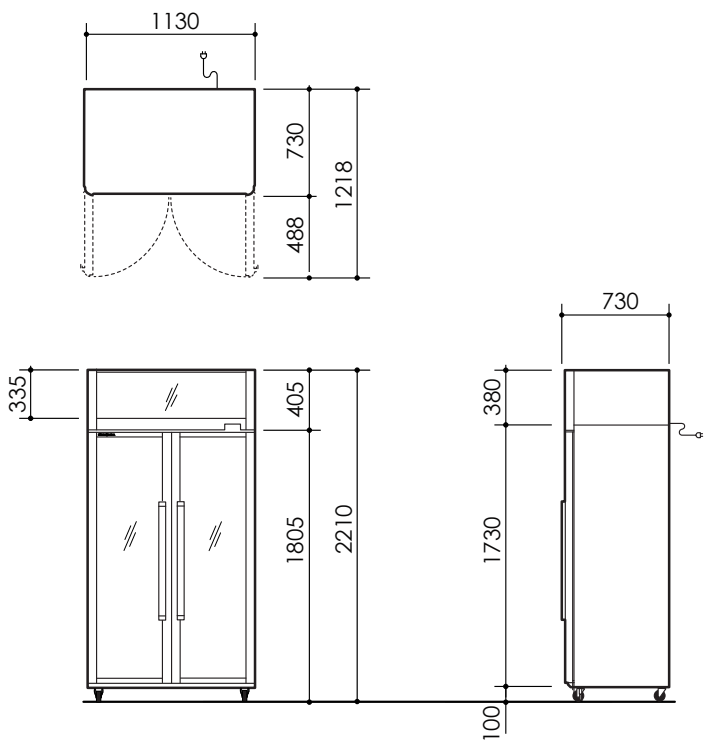

Cabinet

Type	ActiveCore		
Finish	Powder-coated galvanised steel		
Insulation	Type	PU foam	
	Thickness (mm)	50	
	Blowing Agent	Cyclo-iso pentane (C5H10/C5H12)	
Doors	Type	Glass swing door (double-glazed, double low-e, argon-filled, toughened, safety glass), tab-locking	
	Opening Size	Height (mm)	1570
		Width (mm)	450
Shelving	Ten wire shelves 10 × adjustable height shelf (500W × 465D)		
Lighting	Sign	1 × 1060 mm, 12 W LED	
	Interior*	2 × 1400 mm, 15 W LED	

Dimensions†

	External	Internal	Packed
Width (mm)	1130	1030	1200
Depth (mm)	730	555	760
Height (mm)	2210 (castors)	1570	2220
Weight (kg)	215		220
Capacity (L)	897		
Footprint (m²)	0.82		

Ventilation (mm)

Top	300	Sides	Not required	Rear	Not required
-----	-----	-------	--------------	------	--------------

Product Loading

Facing	330 ml can	70	600 ml bottle	70
Loading	330 ml can	490	600 ml bottle	420

Dimensional Tolerances

† Allow for dimensional tolerances when installing the cabinet(s).

Linear dimensions	Single cabinet	Multiple cabinets	
		At each joint	At each end wall
Less than 1 metre	±5 mm	±5 mm	+15 mm
More than 1 metre	-5 mm to +10 mm	-5 mm to +10 mm	+15 mm

Performance

Product Temperature Range (°C)	1 to 4 (adjustable* from 1 to 15)
Maximum Ambient Temperature (°C)	40
Sound Power Level (dB(A))	60.2

Greenhouse and Energy Minimum Standards (GEMS)

Star Rating	9
Product Temperature Class	M1 (-1 to 5°C)
Total Energy Consumption	2.88 kWh/24 h
Annual Running Costs	\$315 (@ \$0.30/kWh)

Electrical

Supply	220-240 volts a.c., 50 Hz, single phase supply
Cord	2.3 m power cord with 3-pin, 10 amp plug
Current draw (A)	1.7

Refrigeration

Controller	SCS Connect (SKOPE-connect™ compatible)		
System Type	Removable cartridge		
Cartridge Weight (kg)	26.5		
Refrigerant/Charge	R290/111 g		
Nominal Capacity (W)	547		
Heat Rejection (W)	Average	120	Peak 170
Defrost Type	Automatic, off-cycle		
Drainage	No plumbing required		

\* Accessible via the free SKOPE-connect™ app.